



1461 S. Blue Island Ave.

CHICAGO, ILLINOIS

Retail Space Available

Along Blue Island between 14th and 15th Streets

FOR MORE INFORMATION,
PLEASE CONTACT

ANDREW BECKER
abecker@canvasrealestate.com
312.231.26009

KATE WYANT
kwyant@canvasrealestate.com
630.730.5239

DEMOGRAPHICS



38.9k+

Total Population
1 Mile

15.5k+ 3.73k+
0.5 Miles 0.25 Miles



\$100k+

Average HH Income
1 Mile

\$99.2k+ \$103k+
0.5 Miles 0.25 Miles



63.1k+

Daytime Population
1 Mile

11.6k+ 2.72k+
0.5 Miles 0.25 Miles



PILSEN

- The two retail spaces are located in The Rosie, a new construction mixed-use development in Chicago's Pilsen neighborhood
- The project is uniquely located between the Illinois Medical District, University Village and Pilsen
- The Rosie, developed by Cedar St., features 202 luxury units in addition to the ground floor retail
- The project is immediately adjacent to Univerity Commons consisting of another 900+ residential units
- The retail spaces have prominent visibility along Blue Island with high ceilings, a massive outdoor area for patio seating and the opportunity for adjacent surface parking
- Ideal for a mix of retail uses including restaurant, convenience, medical and fitness
- Area co-tenants include Hai Sous, S.K.Y., Honky Tonk BBQ, La Luna, Giordano's, La Vaca, Pilsen Yards, Simone's and University Commons

CANVAS

SITE PLAN

SPACE AVAILABLE



+/- **2,036** sqft

Northeast corner of 15th

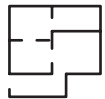

+/- **4,912** sqft

Southeast corner of 14th

Retail Two can be demised into two separate spaces measuring 1,689 sf & 2,674 sf

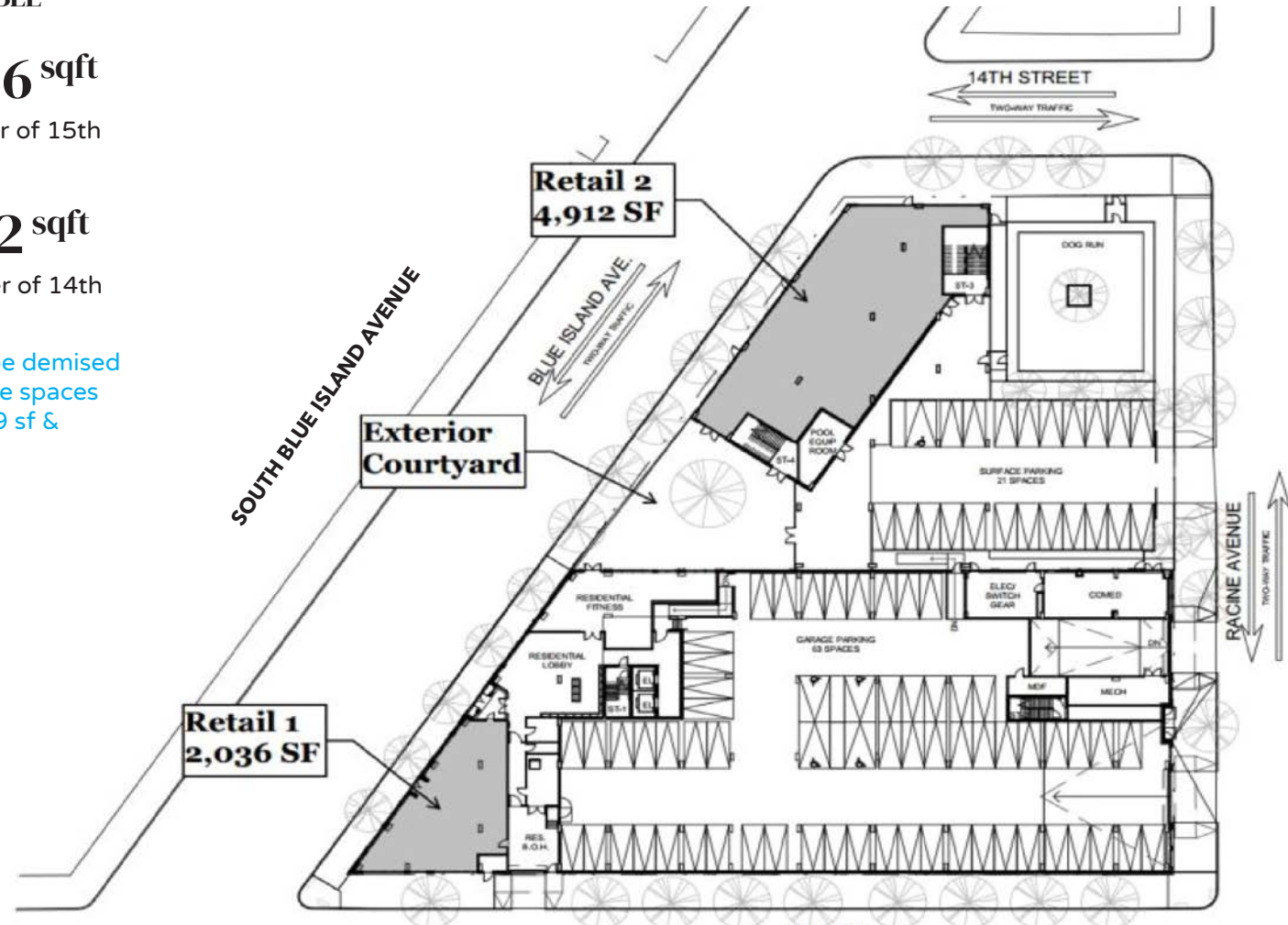

STREET MAP

1461 S. Blue Island
CHICAGO, ILLINOIS

SPACE AVAILABLE

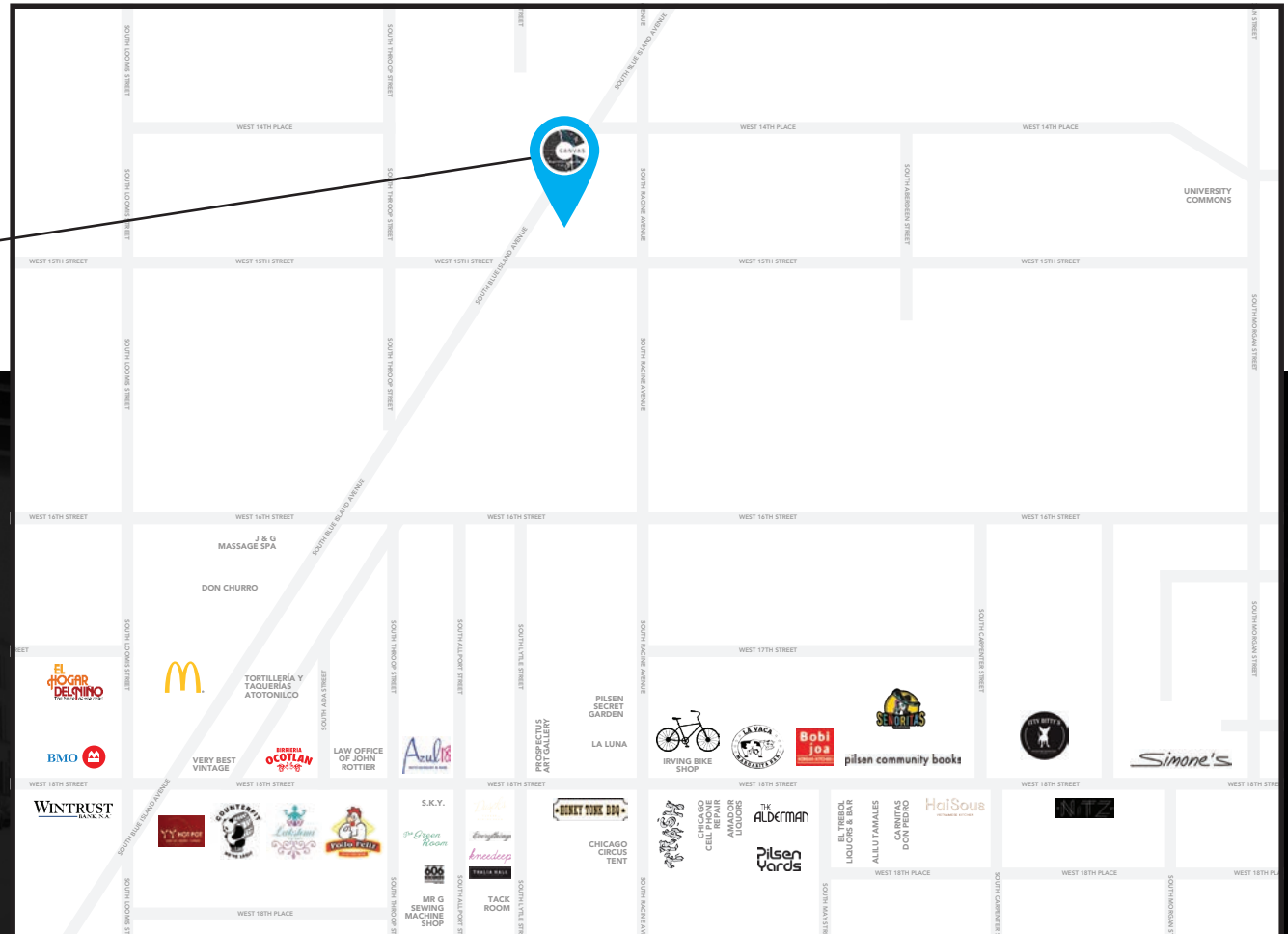
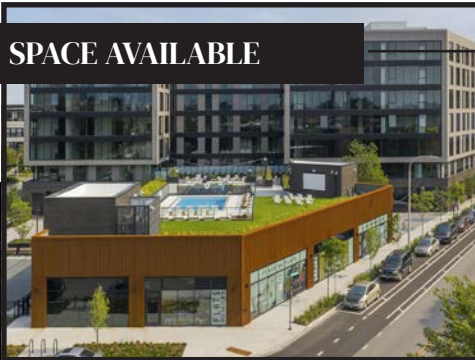

FOR MORE INFORMATION,
PLEASE CONTACT

ANDREW BECKER
abecker@canvasrealestate.com
312.231.2600

KATE WYANT
kwyant@canvasrealestate.com
630.730.5239