



2127 W. Division Street

CHICAGO, ILLINOIS

Restaurant/Retail Space Available
South block between Leavitt and Hoyne

FOR MORE INFORMATION, PLEASE CONTACT

ANTHONY CAMPAGNI • 847.651.8669
ac@canvasrealestate.com

ELAN RASANSKY • 414.380.1555
elan@canvasrealestate.com

KATE WYANT • 630.730.5239
kwyant@canvasrealestate.com

EXISTING CONDITIONS



CANVAS

FLOOR PLANS

SPACE AVAILABLE

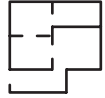

2,600 sqft

Ground Level

FRONTAGE



30 ft

W. Division Street

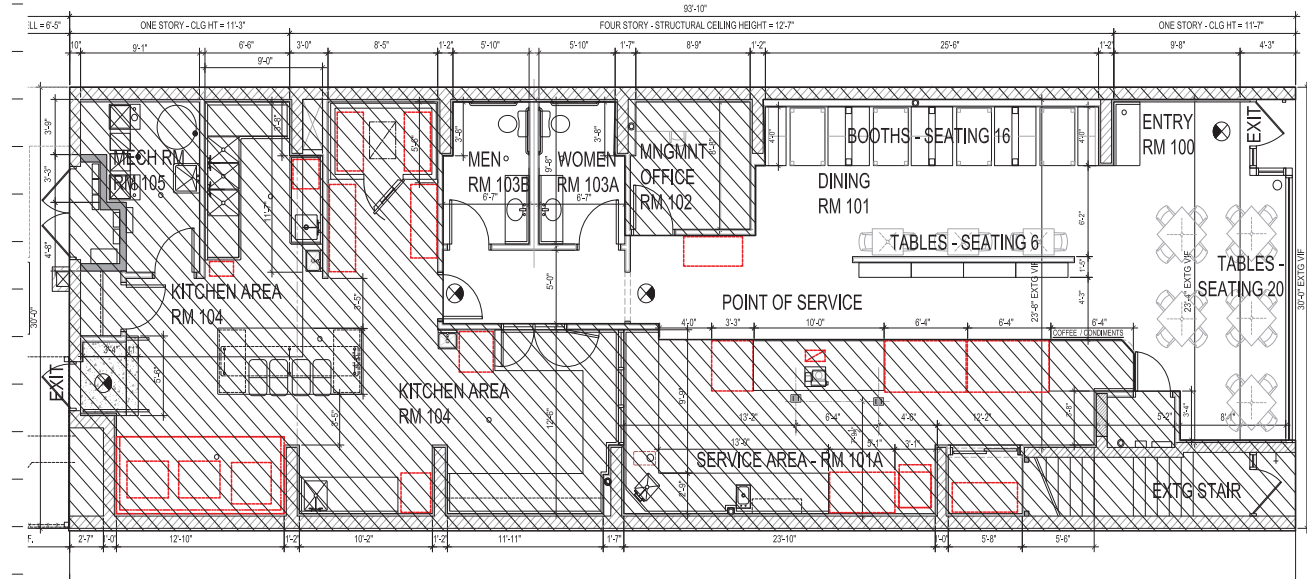

W. DIVISION STREET

DEMOGRAPHICS



76.5k+

Total Population
1 Mile

19.8k+ 4.10k+
0.5 Miles 0.25 Miles



\$170k+

Average HH Income
1 Mile

\$172k+ \$182k+
0.5 Miles 0.25 Miles



57.7k+

Daytime Population
1 Mile

15.2k+ 4.51k+
0.5 Miles 0.25 Miles

WICKER PARK

- Formerly occupied by Kanela Breakfast Club.
- Existing restaurant infrastructure (including black iron ventilation and additional FF&E still in place).
- Extra wide sidewalk/outdoor seating available

NEIGHBORING RETAILERS

Athletico, Dunkin Donuts, Enoteca Roma Osteria Rusticana, Folklore – Argentine Restaurant, Letizia's Natural Bakery, Lost Larson, Queen Mary

CANVAS



STREET MAP

2127 W. Division Street
CHICAGO, ILLINOIS

SPACE AVAILABLE



FOR MORE INFORMATION,
PLEASE CONTACT

ANTHONY CAMPAGNI

ac@canvasrealestate.com

847.651.8669

ELAN RASANSKY

elan@canvasrealestate.com

414.380.1555

KATE WYANT

kwyant@canvasrealestate.com

630.730.5239



CANVAS