



28 S. Wabash Avenue
CHICAGO, ILLINOIS

Sullivan Center Restaurant Space Available

West block of Wabash between
Madison and Monroe

FOR MORE INFORMATION,
PLEASE CONTACT

ANTHONY CAMPAGNI
ac@canvasrealestate.com
847.651.8669

ELAN RASANSKY
elan@canvasrealestate.com
414.380.1555

QUINN THOMAS
qthomas@canvasrealestate.com
847.651.5589



DEMOGRAPHICS



93.3k+
Total Population
1 Mile

14.9k+ 3.42k+
0.5 Miles 0.25 Miles



\$184k+
Average HH Income
1 Mile

\$202k+ \$250k+
0.5 Miles 0.25 Miles



524k+
Daytime Population
1 Mile

258k+ 62.2k+
0.5 Miles 0.25 Miles

THE LOOP

- Second generation restaurant space
- The Sullivan Center, a one million square foot retail and office complex located in the heart of the Center Loop District in Downtown Chicago, is one of the city's iconic structures and home to a number of retail and global office users
- One block south of new CTA Washington/Wabash station, 10,000 riders daily
- One block west of Millennium Park, Chicago's most popular tourist attraction with 25 million visitors per year
- Surrounding neighbors include Vans, 32 South State - Jordon Store, Fairgrounds Craft Coffee and Tea, Nordstrom Rack, Target, Shake Shack, and Goddess and the Baker
- Surrounding hotels include Chicago Athletic Association and Palmer House a Hilton Hotel



CANVAS

FLOOR PLAN

SPACE AVAILABLE



2,413 sqft

Ground Level

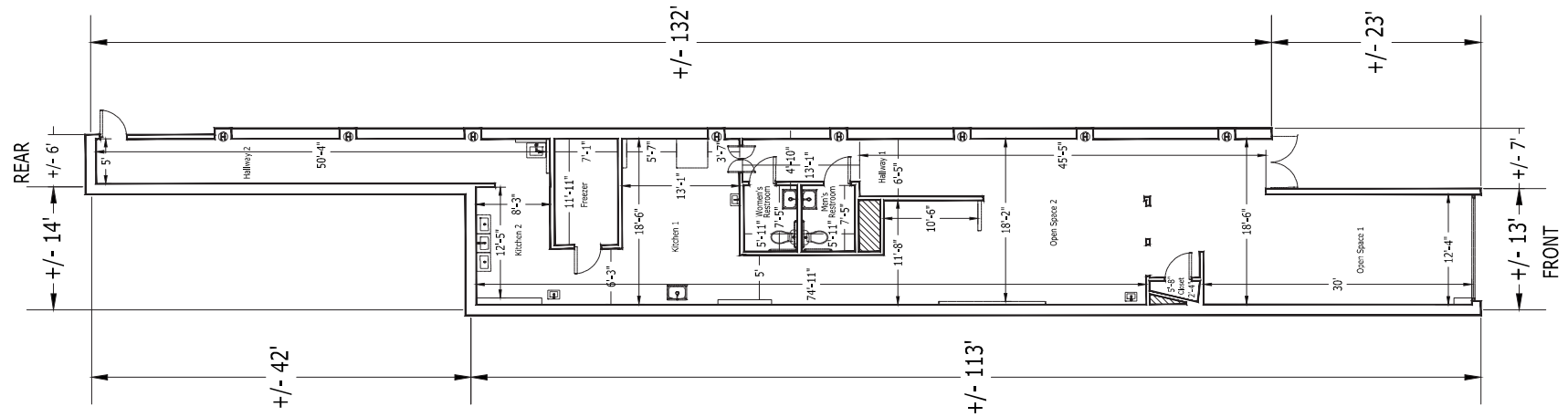

SOUTH WABASH AVENUE

CANVAS



SITE PLAN

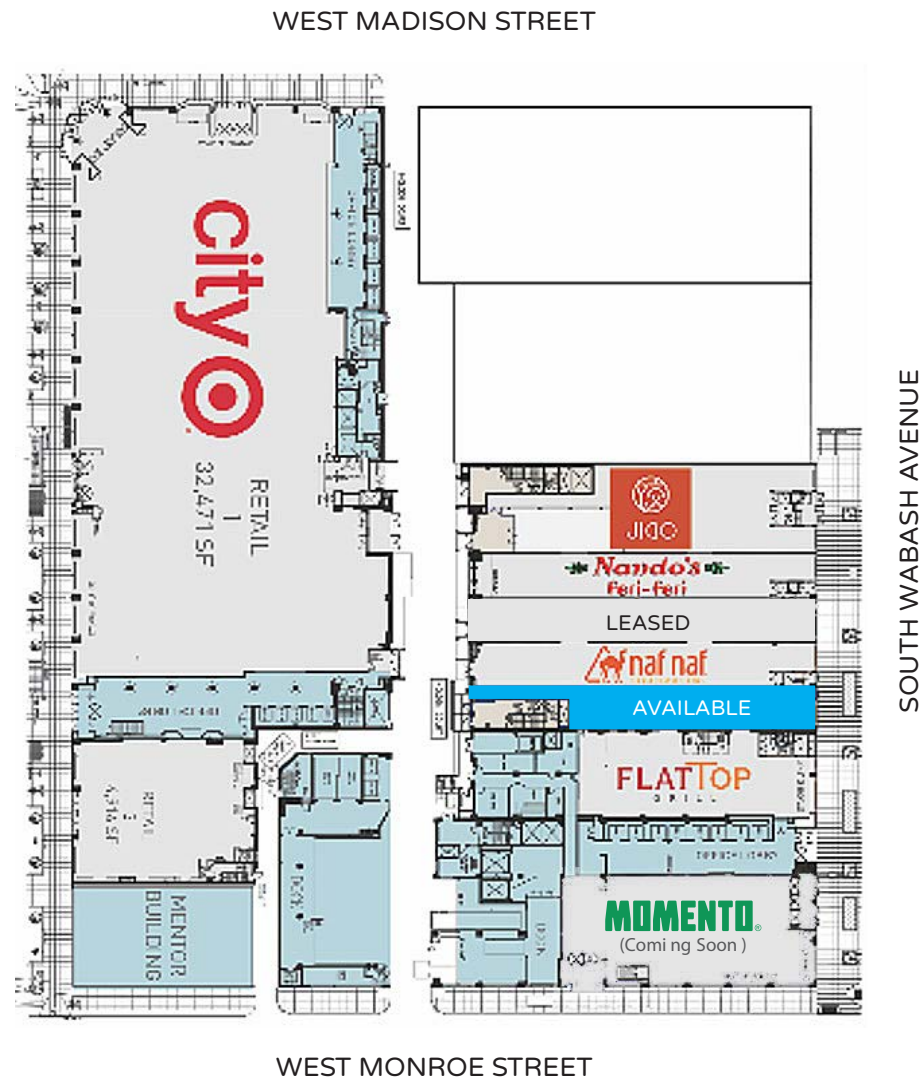

CANVAS



STREET MAP

28 S. Wabash Avenue
CHICAGO, ILLINOIS

SPACE AVAILABLE

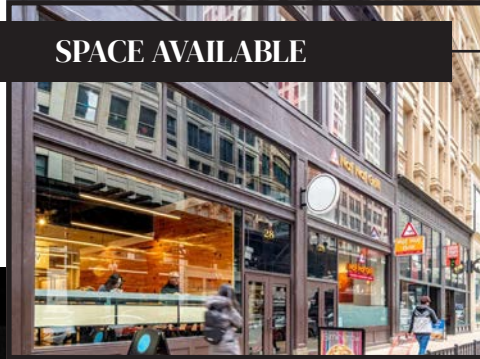

FOR MORE INFORMATION,
PLEASE CONTACT

ANTHONY CAMPAGNI
ac@canvasrealestate.com
847.651.8669

ELAN RASANSKY
elan@canvasrealestate.com
414.380.1555

QUINN THOMAS
qthomas@canvasrealestate.com
847.651.5589

CANVAS

