



1501 N. Kingsbury Street

CHICAGO, ILLINOIS

Retail Space for Lease
 Northeast corner of Kingsbury and Blackhawk

FOR MORE INFORMATION, PLEASE CONTACT

ANTHONY CAMPAGNI • 847.651.8669
 ac@canvasrealestate.com

ELAN RASANSKY • 414.380.1555
 elan@canvasrealestate.com

QUINN THOMAS • 847.651.5589
 qthomas@canvasrealestate.com

DEMOGRAPHICS



59.9k+

Total Population
1 Mile

6.03k+ 1.12k+
0.5 Miles 0.25 Miles



\$194k+

Average HH Income
1 Mile

\$201k+ \$152k+
0.5 Miles 0.25 Miles



62.2k+

Daytime Population
1 Mile

14.7k+ 7.95k+
0.5 Miles 0.25 Miles



LINCOLN PARK

- Highly visible corner adjacent to iO Theater and across from the 2nd highest grossing Whole Foods in the country
- Opportunity to install a new glass storefront with outdoor seating wrapping the corner
- Black iron capable with existing operable restrooms
- Over \$500M in retail sales in the trade area.

NEIGHBORING RETAILERS



iO@THEATER



BRITISH
INTERNATIONAL SCHOOL
OF CHICAGO, LINCOLN PARK
A NORD ANGLIA EDUCATION SCHOOL

PETSMART



Northwestern
Medicine



DSW
DESIGNER SHOE WAREHOUSE

NORDSTROM
rack



CANVAS

FLOOR PLAN

SPACE AVAILABLE

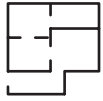

3,000 sqft

Ground Floor

FRONTAGE

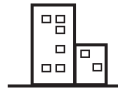

40 ft

on Kingsbury Street

80 ft

on Blackhawk Street

NORTH KINGSBURY STREET

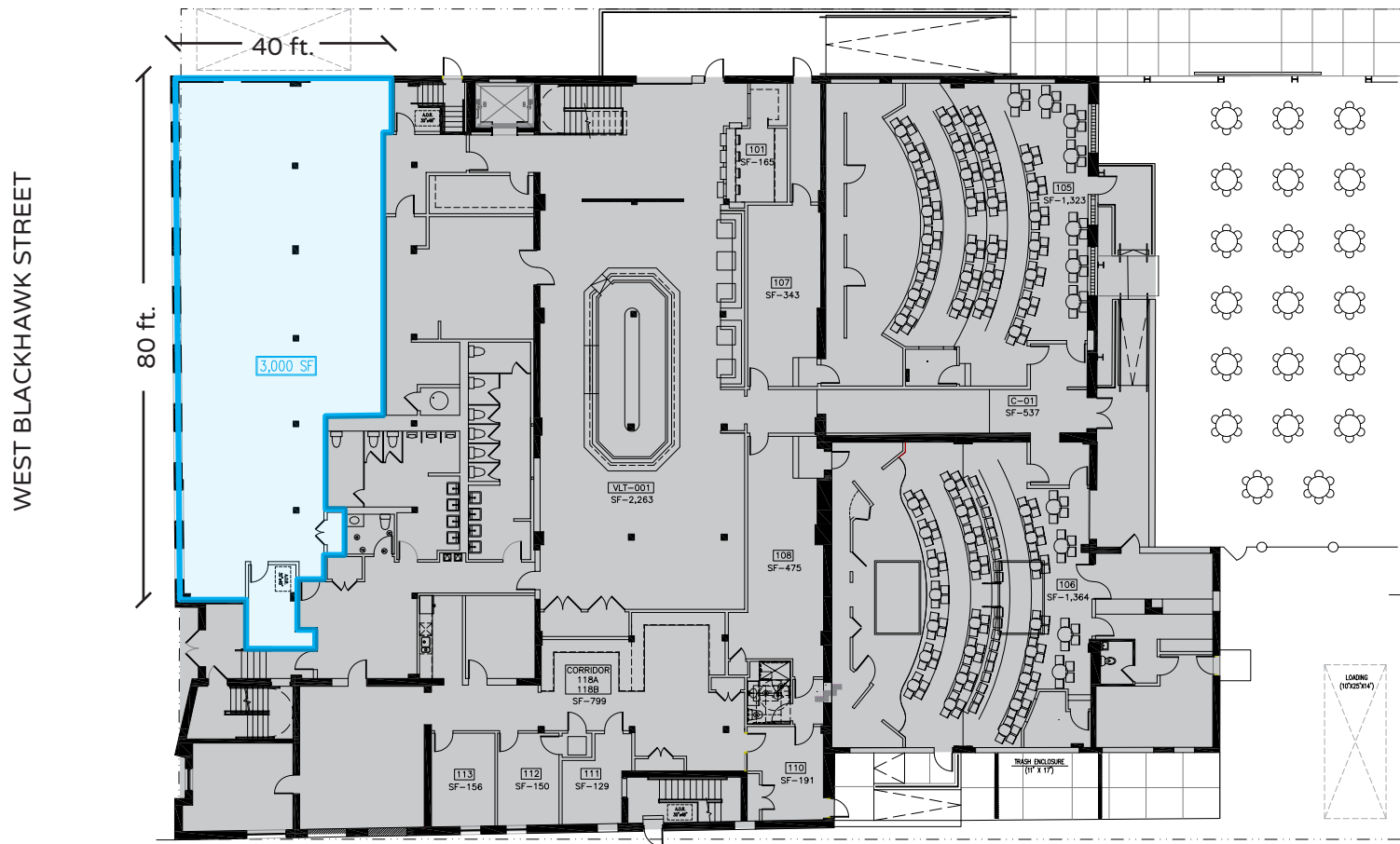

CANVAS



AERIAL MAP

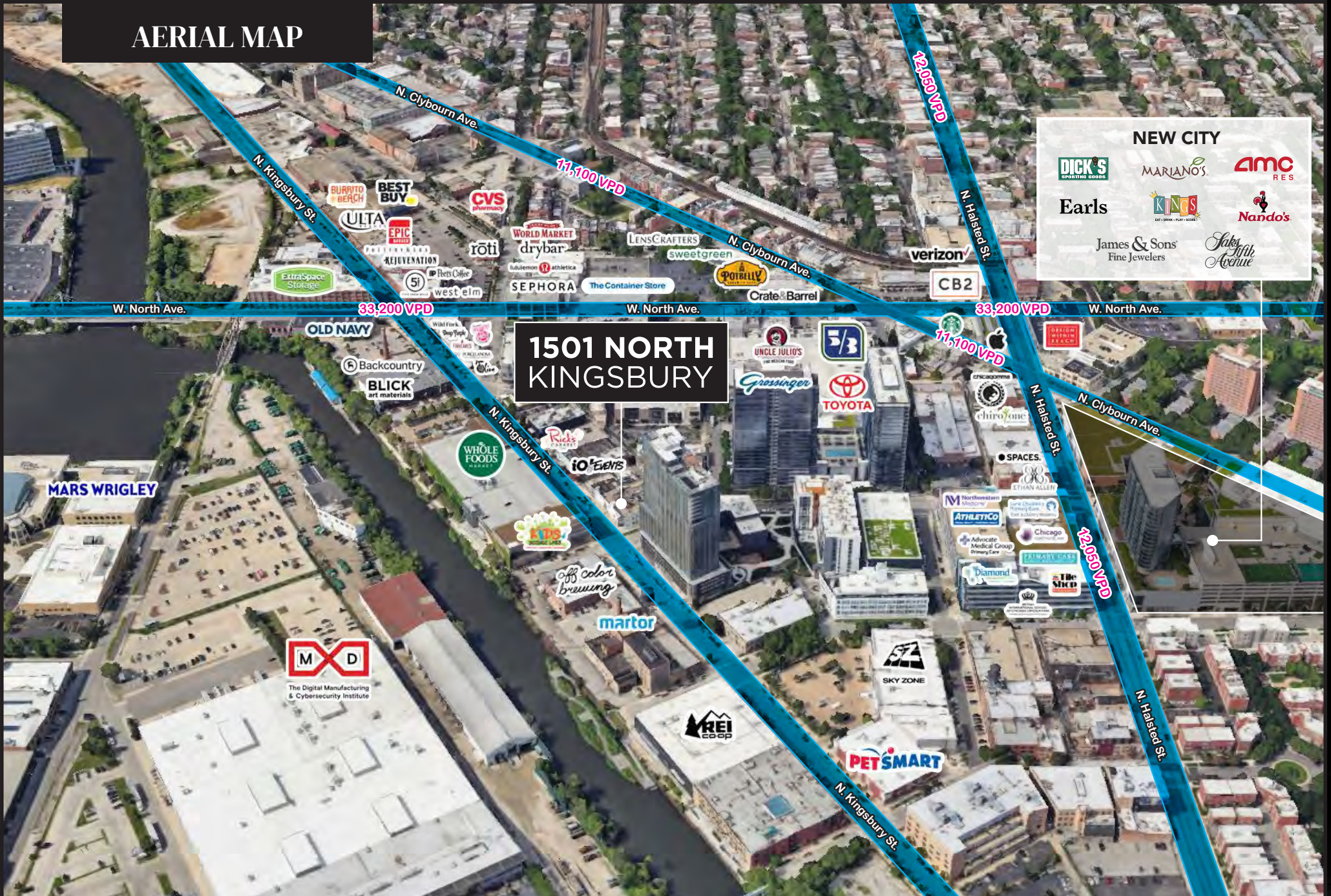

NEW CITY

STREET MAP

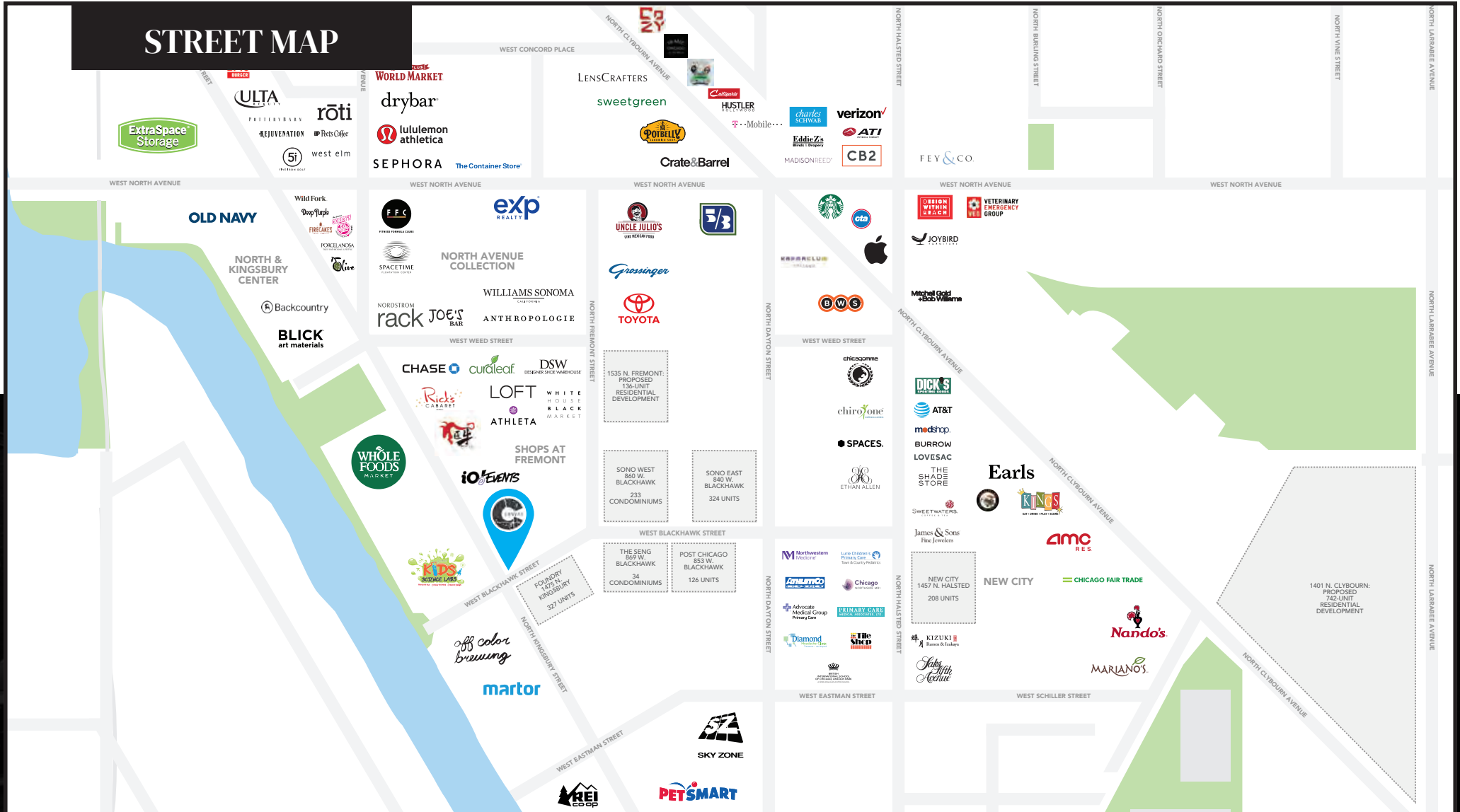

FOR MORE INFORMATION, PLEASE CONTACT

ANTHONY CAMPAGNI
 ac@canvasrealestate.com
 847.651.8669

ELAN RASANSKY
 elan@canvasrealestate.com
 414.380.1555

QUINN THOMAS
 qthomas@canvasrealestate.com
 847.651.5589



CANVAS