

Park Avenue West Commons



2060-2090 Skokie Valley Rd
HIGHLAND PARK, ILLINOIS

Retail Space Available For Lease
Southwest of Skokie Valley Road

FOR MORE INFORMATION,
PLEASE CONTACT

MICHAEL WEXLER
mwexler@canvasrealestate.com
773.426.1759

MICHAEL WALLACE
mwallace@canvasrealestate.com
614.537.2403

DEMOGRAPHICS



113k+

Total Population
5 Miles

56.9k+ 6.85k+
3 Miles 1 Mile



\$232k+

Average HH Income
5 Miles

\$225k+ \$213k+
3 Miles 1 Mile



176k+

Daytime Population
5 Miles

65.9k+ 6.49k+
3 Miles 1 Mile



HIGHLAND PARK

- Join a mix of service-oriented retail catering to people's everyday needs
- High visibility from Skokie Valley Rd with over 51,800 vpd and great signage across 3 pylon signs
- Easy access, multiple access points including a traffic light at the intersection of Park Ave west and Skokie Valley Rd
- Perfect opportunity for a variety of retail uses, including salon, medical, dentistry, spa, f&b fast casual and more
- \$210,490 Average household income within 5 mile radius
- Porsche Exchange coming soon to the corner of Park Ave West and Skokie Valley Road

NEIGHBORING TENANTS



TARGET



TREK

STAPLES



CANVAS

FLOOR PLAN

SPACE AVAILABLE

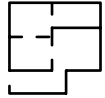

2,216 sqft

Total

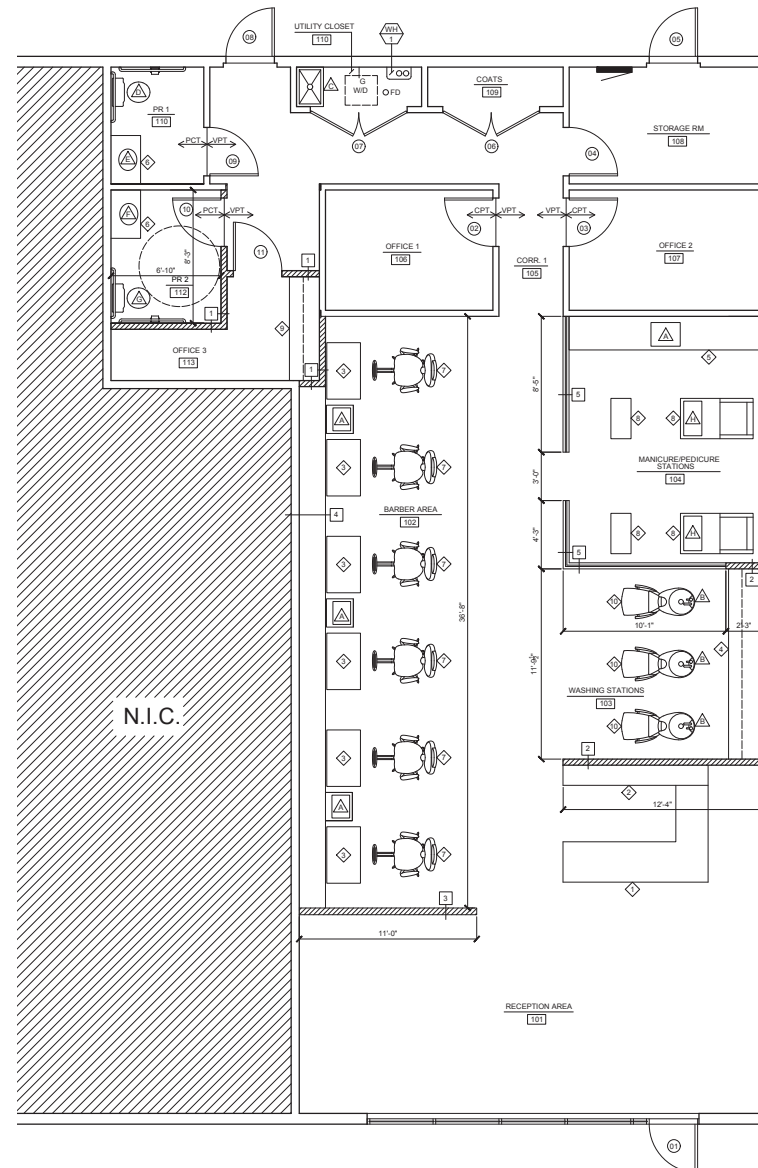

CANVAS



SITE PLAN

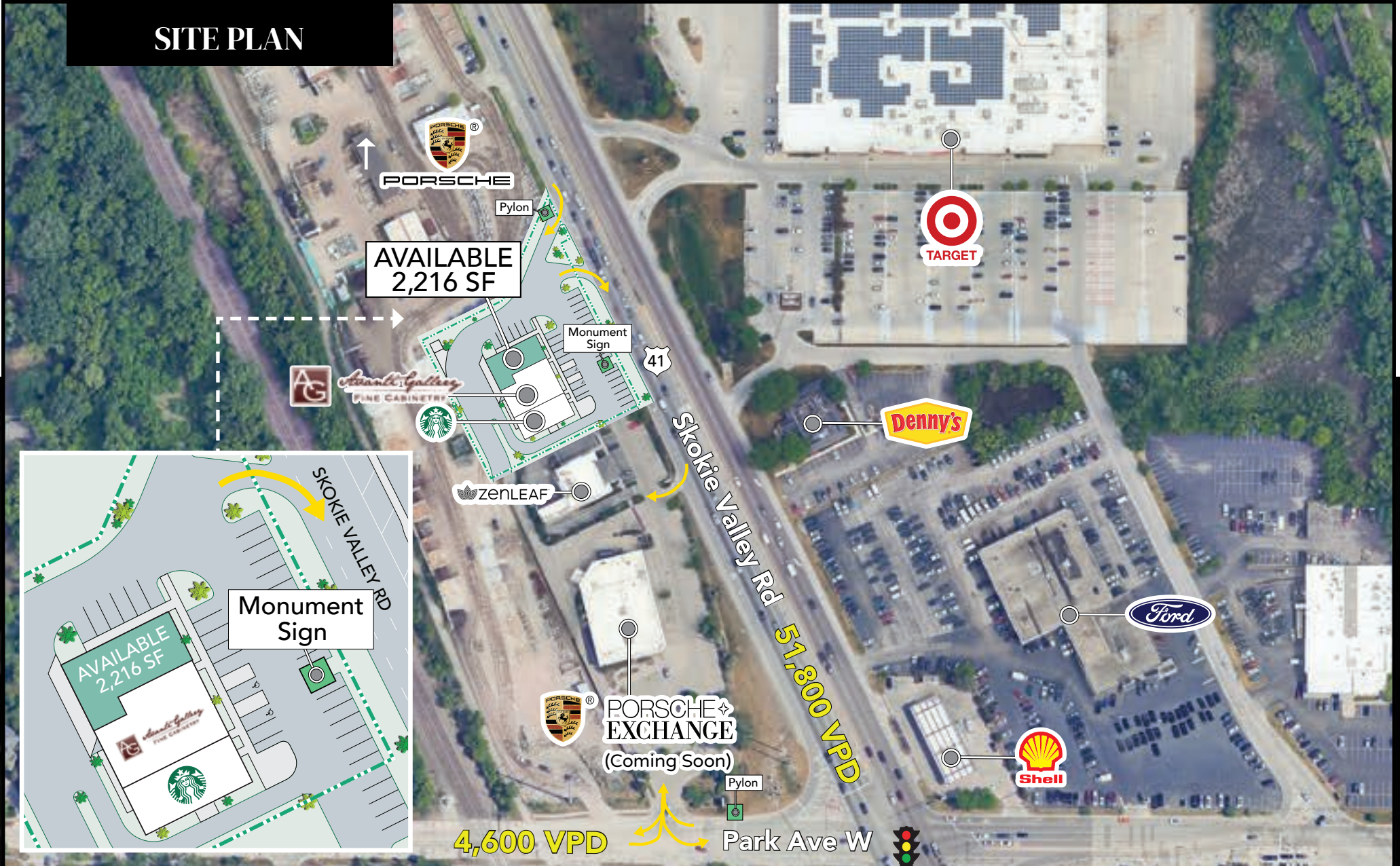

AERIAL LOCATION



FOR MORE INFORMATION,
PLEASE CONTACT

MICHAEL WEXLER
mwexler@canvasrealestate.com
773.426.1759

MICHAEL WALLACE
mwallace@canvasrealestate.com
614.537.2403



CANVAS