

# Park Avenue West Commons



**2060-2090 Skokie Valley Rd**  
HIGHLAND PARK, ILLINOIS

Retail Space Available For Lease  
Southwest of Skokie Valley Road

FOR MORE INFORMATION,  
PLEASE CONTACT

MICHAEL WEXLER  
mwexler@canvasrealestate.com  
773.426.1759

MICHAEL WALLACE  
mwallace@canvasrealestate.com  
614.537.2403

# DEMOGRAPHICS



**113k+**

Total Population  
5 Miles

56.9k+ 6.85k+  
3 Miles 1 Mile



**\$232k+**

Average HH Income  
5 Miles

\$225k+ \$213k+  
3 Miles 1 Mile



**176k+**

Daytime Population  
5 Miles

65.9k+ 6.49k+  
3 Miles 1 Mile



## HIGHLAND PARK

- Join a mix of service-oriented retail catering to people's everyday needs
- High visibility from Skokie Valley Rd with over 51,800 vpd and great signage across 3 pylon signs
- Easy access, multiple access points including a traffic light at the intersection of Park Ave west and Skokie Valley Rd
- Perfect opportunity for a variety of retail uses, including salon, medical, dentistry, spa, f&b fast casual and more
- \$210,490 Average household income within 5 mile radius

## NEIGHBORING TENANTS



CANVAS

# FLOOR PLAN

SPACE AVAILABLE

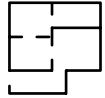

**2,216** sqft

Total

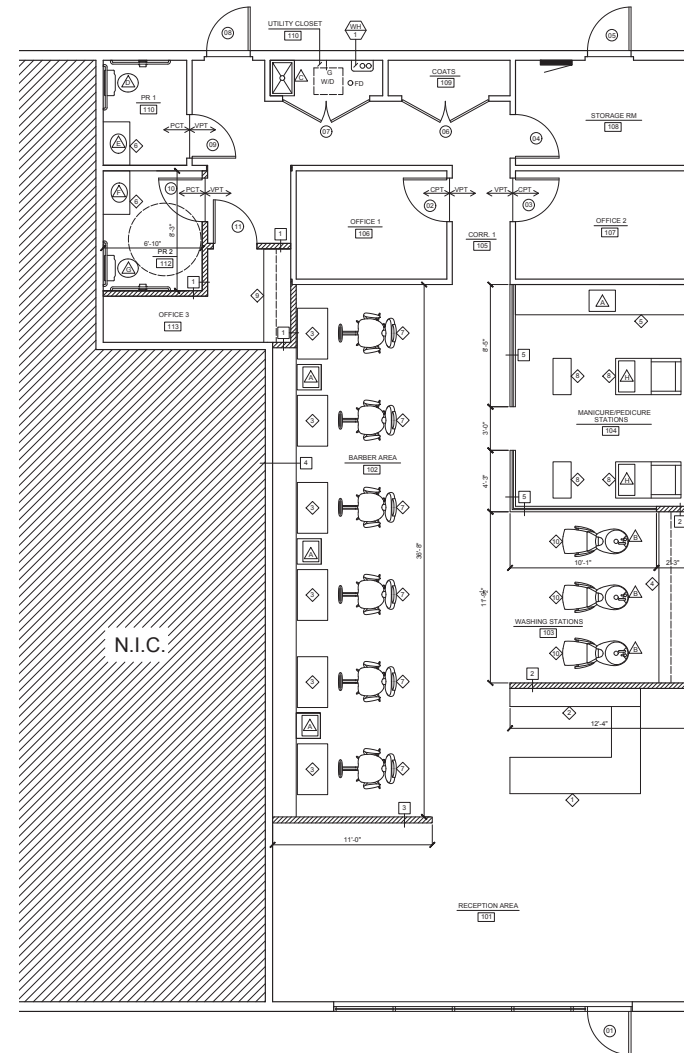

CANVAS



# SITE PLAN

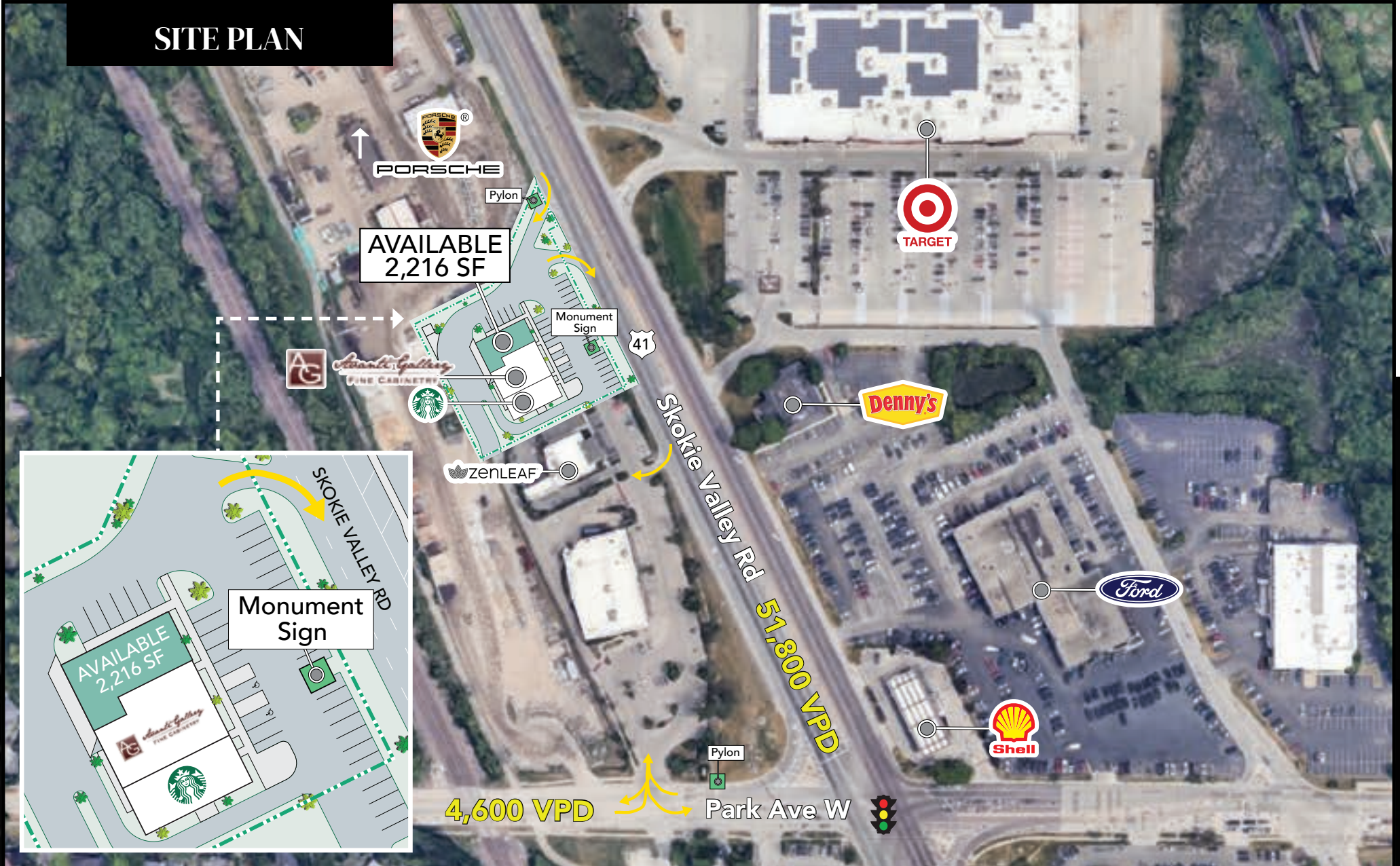

# AERIAL LOCATION



FOR MORE INFORMATION,  
PLEASE CONTACT

MICHAEL WEXLER  
mwexler@canvasrealestate.com  
773.426.1759

MICHAEL WALLACE  
mwallace@canvasrealestate.com  
614.537.2403



CANVAS