



# 310

N. PEORIA

INCREDIBLE FULTON MARKET OPPORTUNITY

CANVAS



# 310

N. PEORIA  
X  
THE NEIGHBORHOOD

**310 N. Peoria** is situated in the heart of Chicago's bustling Fulton Market District steps from Lyra, Time Out Market, Rosemary, Aba, Gibson's, Sunda, Studio Three and other best-in-class operators. Ideal for retailers, restaurants or showrooms looking to capitalize on the true live, work, play environment Fulton Market has to offer.

Join Chicago's hottest sub-market alongside some of the country's most coveted restaurant and retail brands.

## RETAIL:

*allbirds* *free people* **patagonia** **FJÄLL RAVEN** BEYOND YOGA BILLY REID WARBY PARKER  
MEJURI **brooklinen** lululemon **athletica** ANTHROPOLOGIE **Aēsop** *Madewell* BRILLIANT EARTH

## RESTAURANT:

εστιατόριο **LYRA** MOMOTARO **PARLOR** *avlí* *aba* BEATRIX **SUNDA**  
**Time Out MARKET** *Au Cheval* **NOBU** **GIBSONS** **BOQUERIA** GIRL & THE GOAT **next**

## HOTEL:

**the hoxton** SOHO HOUSE **NOBU HOTEL** *the emily hotel* **HYATT house**

# 310

N. PEORIA  
X  
THE OPPORTUNITY

## Property Highlights

- A unique opportunity to lease two-levels of retail/restaurant space in a fully redeveloped boutique mixed-use building
- 4,250 SF on First Floor + 6,250 SF on Lower Level
- Single level or bi-level space plans available
- 14' ceiling heights
- Elevated covered patio along Wayman running the length of the building



# 310

N. PEORIA

X

STACKING PLAN



**fifth floor** | office

**fourth floor** | office

**third floor** | office

**second floor** | office

**first floor** | retail/restaurant

**lower level** | retail/restaurant

# 310

N. PEORIA

X  
FLOOR PLAN

SIZE

4,250<sup>SF</sup>

FIRST FLOOR (RAISED)

+

6,250<sup>SF</sup>

LOWER LEVEL

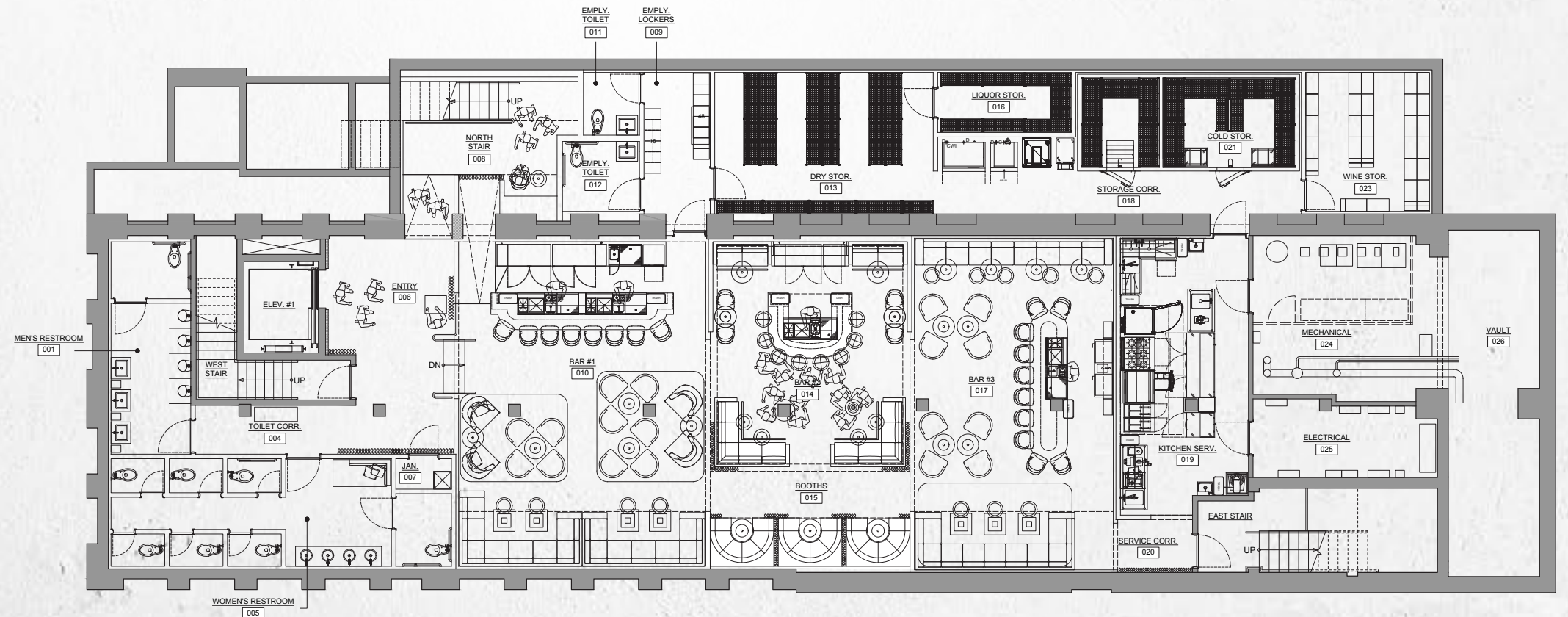
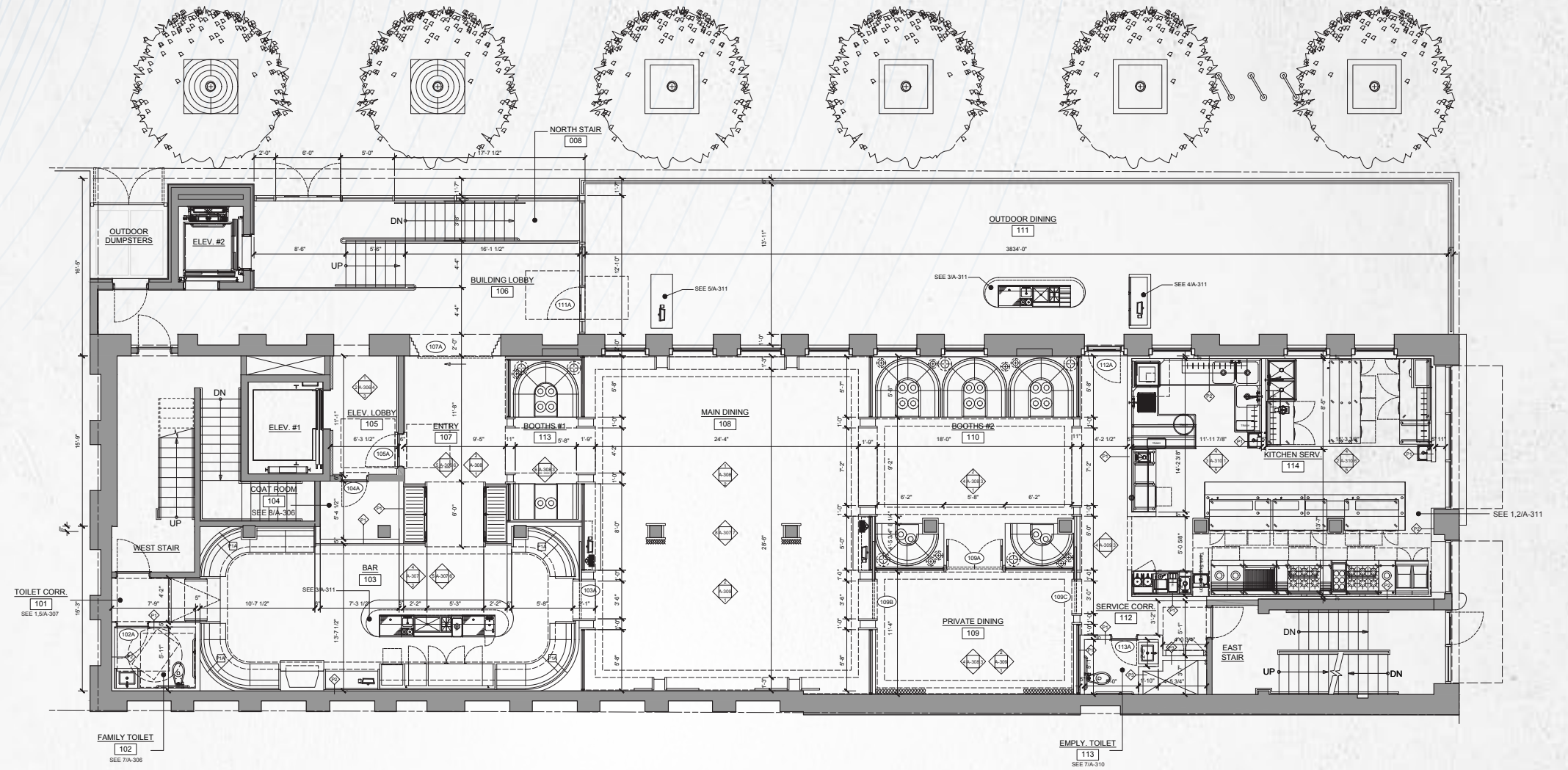

# 310

N. PEORIA  
X  
DEMOGRAPHICS



**\$192,545**  
**Average HHI**  
1 Mile Radius

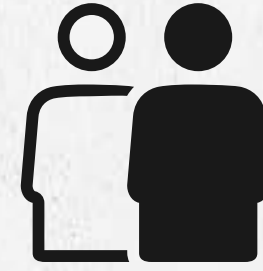

**319,462**  
**Daytime Population**  
1 Mile Radius



**69,492**  
**Population**  
1 Mile Radius



# 310

## N. PEORIA

X

### RETAIL MAP

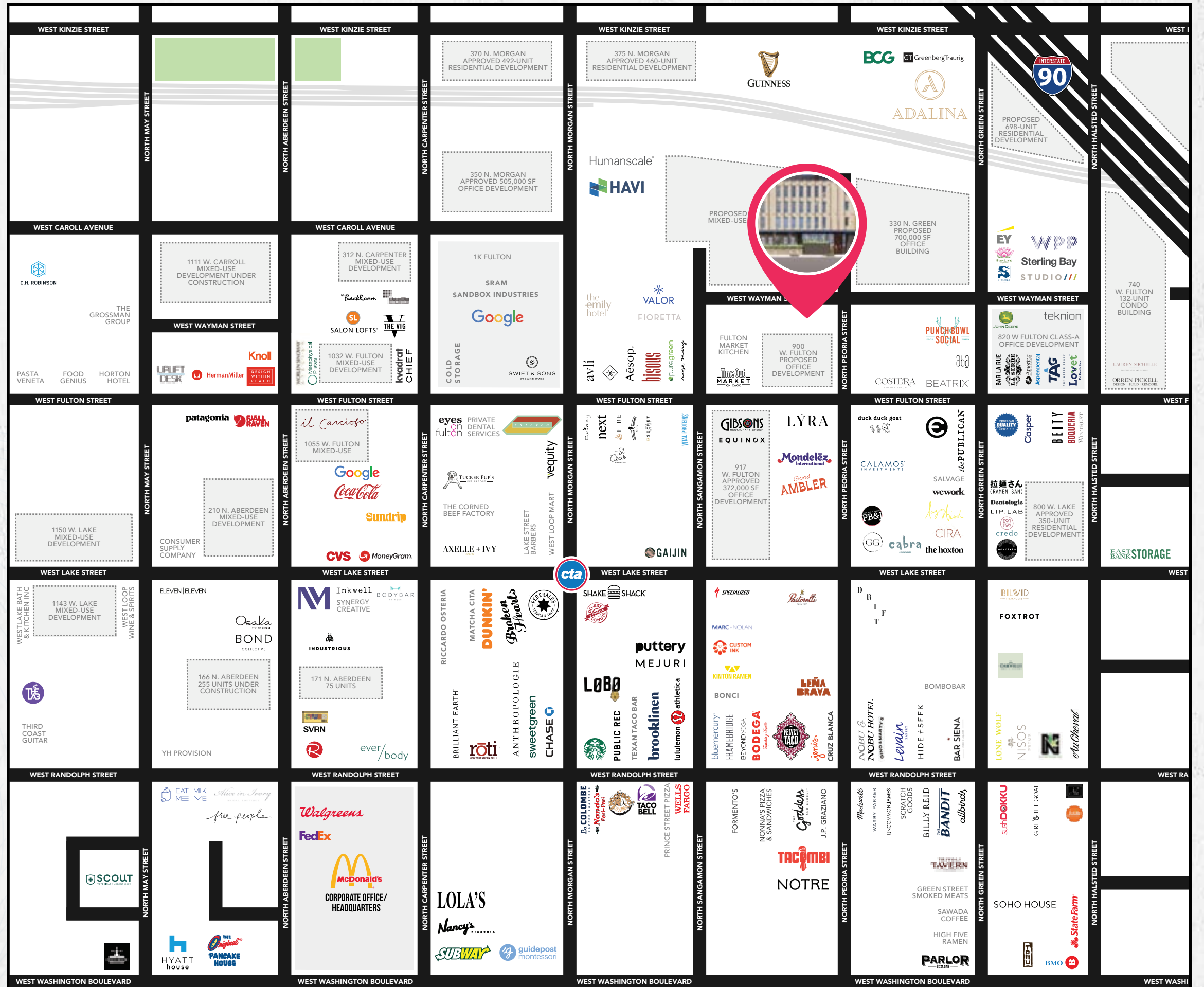

# 310

## N. PEORIA

INCREDIBLE FULTON MARKET OPPORTUNITY



**MICHAEL WEXLER**  
mwexler@canvasrealestate.com  
773.426.1759

**JOHN BASSI**  
jbassi@canvasrealestate.com  
708.822.4583

**ANDREW BECKER**  
abecker@canvasrealestate.com  
312.231.2600