



3730 N. Southport Avenue

CHICAGO, ILLINOIS

Retail/Restaurant Opportunity for Lease
West block of Southport between Grace and Waveland

FOR MORE INFORMATION, PLEASE CONTACT
ANTHONY CAMPAGNI • 847.651.8669
ac@canvasrealestate.com

ELAN RASANSKY • 414.380.1555
elan@canvasrealestate.com

QUINN THOMAS • 847.651.5589
qthomas@canvasrealestate.com

DEMOGRAPHICS



84.2k+

Total Population
1 Mile

18.3k+ 5.37k+
0.5 Miles 0.25 Miles



\$172k+

Average HH Income
1 Mile

\$197k+ \$203k+
0.5 Miles 0.25 Miles



61.9k+

Daytime Population
1 Mile

13.3k+ 3.39k+
0.5 Miles 0.25 Miles



LAKEVIEW

- Unique free-standing two-tenant building located on North Southport Avenue, just north of Addison.
- The opportunity is just north of one of the most successful retail corridors in Chicago – The Southport Corridor.
- The property is in close proximity to Candyality, CVS, Jewel Osco, The Music Box Theatre, Steingold's Deli, and Tango Sure. The exterior storefront can be customized by a tenant for maximum branding ability.
- Outdoor seating and potentially rooftop seating also available.
- 2 blocks from Wrigley Field and CTA Public Transit Stop.
- Less than 1 block from Blaine Elementary (876 Students).

NEIGHBORING RETAILERS

Anthropologie, Big City Optical, Bluemercury, Dr. Martens, DQ, Jeni's, Jewel-Osco, Lululemon, Lush, Subway, Madewell, Warby Parker, Sweetgreen, Starbucks

CANVAS

FLOOR PLAN

SPACE AVAILABLE



3,800 sqft

Total

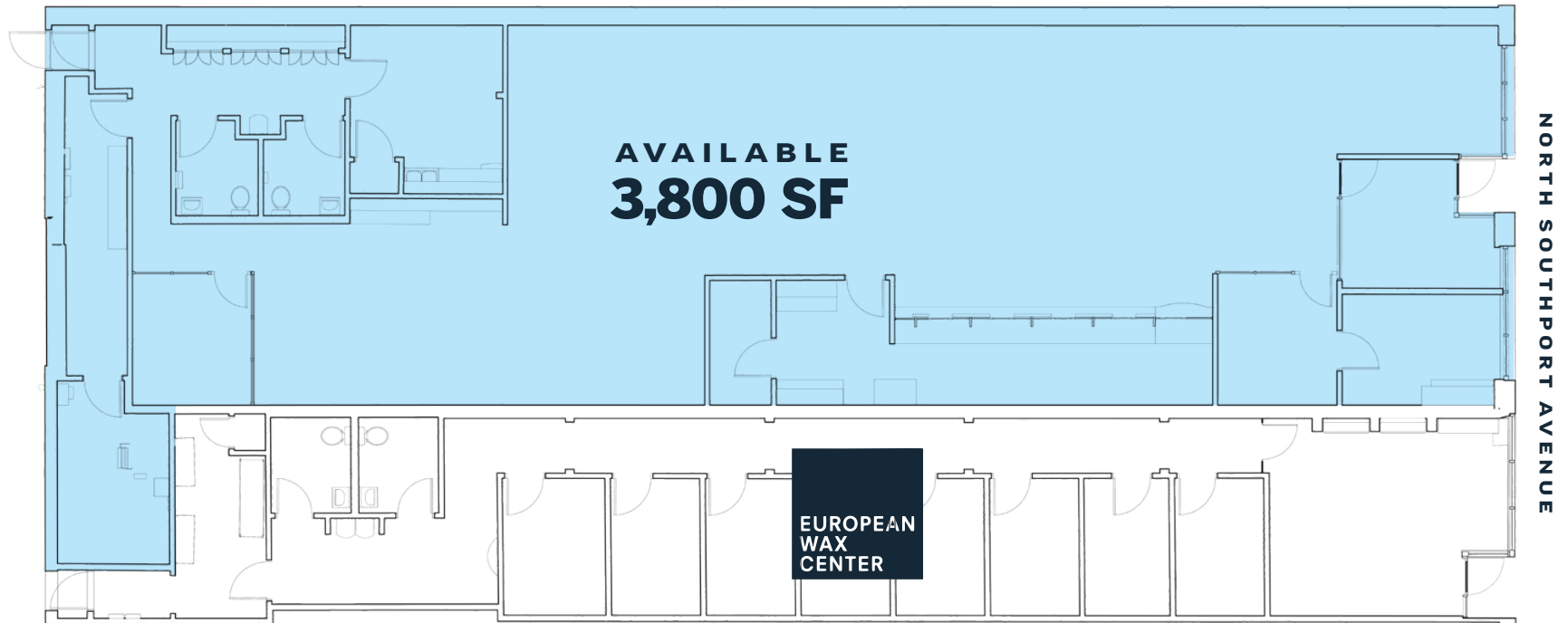

CANVAS



TWO-TENANT DEMISED SCENARIO

SPACE AVAILABLE



2,232.67 sqft

Tenant A



1,467.52 sqft

Tenant B

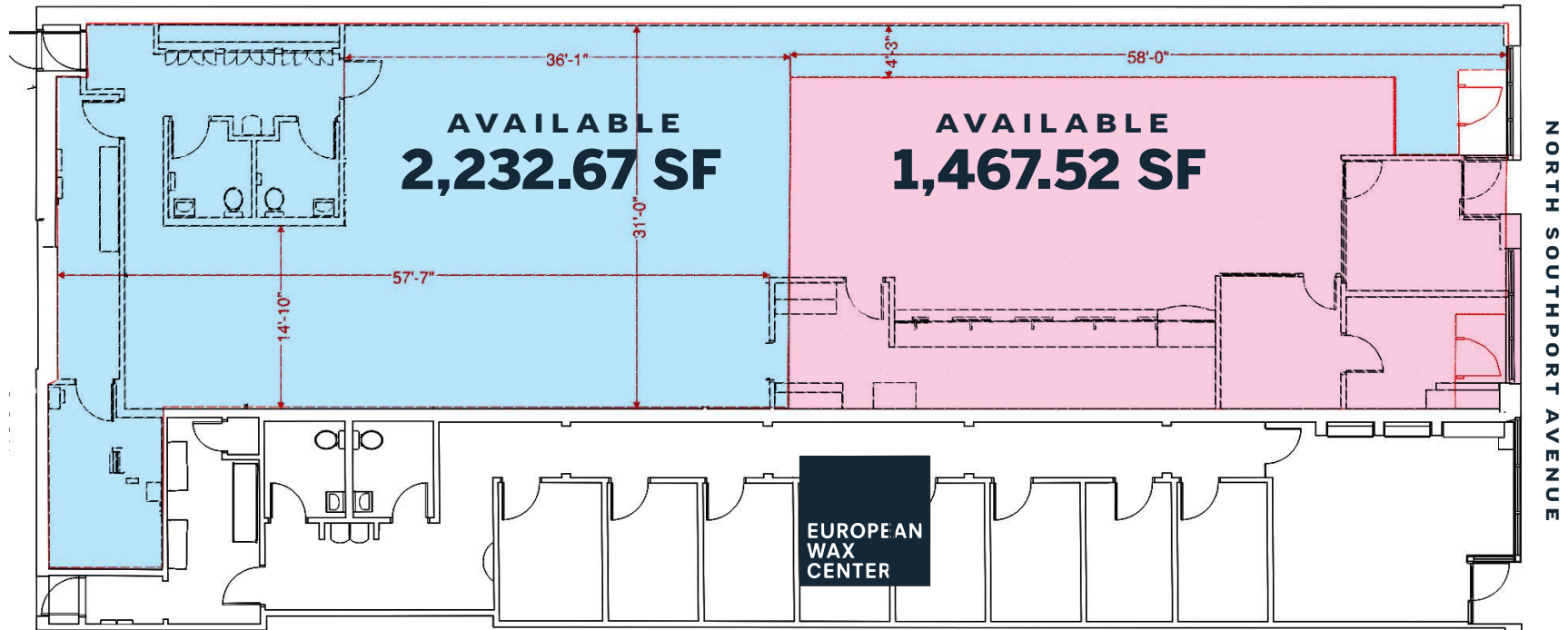

CANVAS



STREET MAP

3730 N. Southport Avenue
CHICAGO, ILLINOIS

SPACE AVAILABLE



**FOR MORE INFORMATION,
PLEASE CONTACT**

ANTHONY CAMPAGNI
ac@canvasrealestate.com
847.651.8669

ELAN RASANSKY
elan@canvasrealestate.com
414.380.1555

QUINN THOMAS
qthomas@canvasrealestate.com
847.651.5589

CANVAS

