



# 3730 N. Southport Avenue CHICAGO, ILLINOIS

**Retail/Restaurant Opportunity for Lease**  
West block of Southport between Grace and Waveland

FOR MORE INFORMATION, PLEASE CONTACT

ANTHONY CAMPAGNI • 847.651.8669  
ac@canvasrealestate.com

ELAN RASANSKY • 414.380.1555  
elan@canvasrealestate.com

QUINN THOMAS • 847.651.5589  
qthomas@canvasrealestate.com



## DEMOGRAPHICS



**84.2k+**

Total Population  
1 Mile

18.3k+      5.37k+  
0.5 Miles      0.25 Miles



**\$172k+**

Average HH Income  
1 Mile

\$197k+      \$203k+  
0.5 Miles      0.25 Miles



**61.9k+**

Daytime Population  
1 Mile

13.3k+      3.39k+  
0.5 Miles      0.25 Miles



## LAKEVIEW

- Unique free-standing two-tenant building located on North Southport Avenue, just north of Addison.
- The opportunity is just north of one of the most successful retail corridors in Chicago – The Southport Corridor.
- The property is in close proximity to Candyality, CVS, Jewel Osco, The Music Box Theatre, Steingold's Deli, and Tango Sure. The exterior storefront can be customized by a tenant for maximum branding ability.
- Outdoor seating and potentially rooftop seating also available.
- 2 blocks from Wrigley Field and CTA Public Transit Stop.
- Less than 1 block from Blaine Elementary (876 Students).

## NEIGHBORING RETAILERS

Anthropologie, Big City Optical, Bluemercury, Dr. Martens, DQ, Jeni's, Jewel-Osco, Lululemon, Lush, Subway, Madewell, Warby Parker, Sweetgreen, Starbucks

CANVAS

# FLOOR PLAN

SPACE AVAILABLE



**3,800** sqft

Total

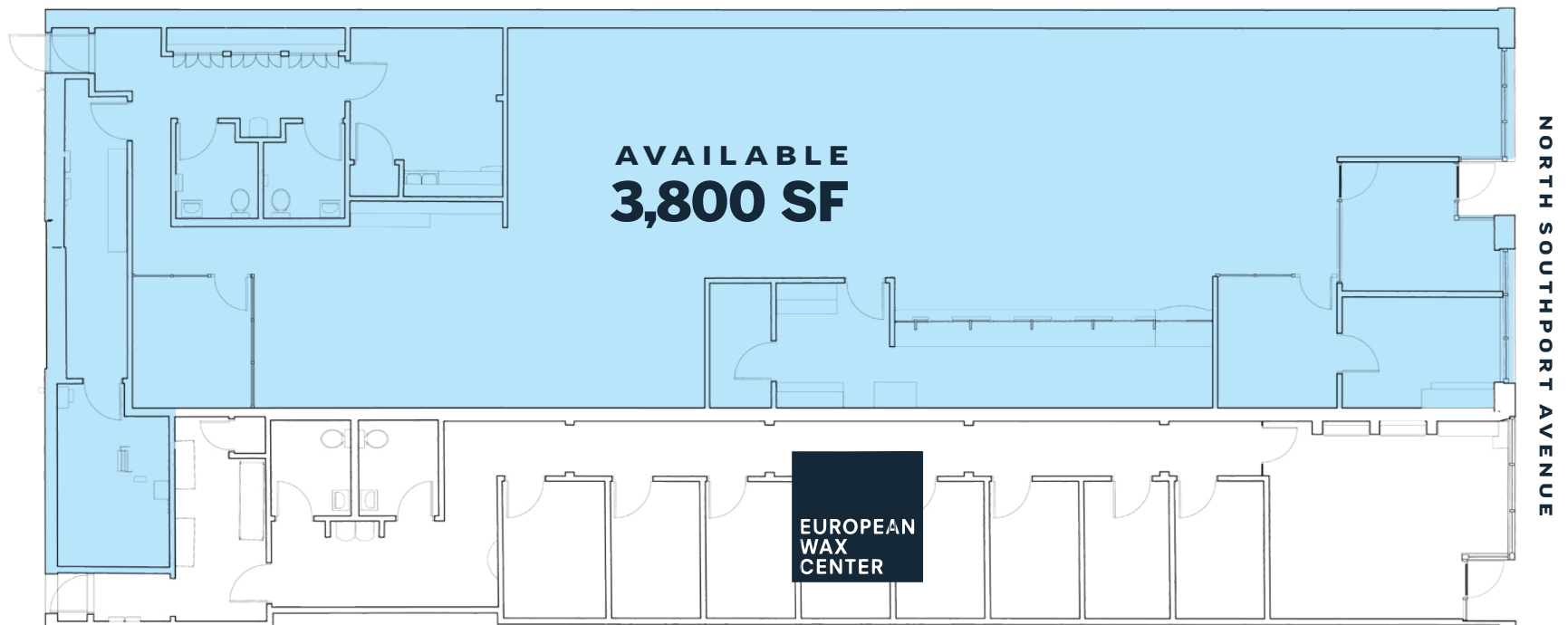

CANVAS



## TWO-TENANT DEMISED SCENARIO

SPACE AVAILABLE



**2,232.67** sqft

Tenant A



**1,467.52** sqft

Tenant B

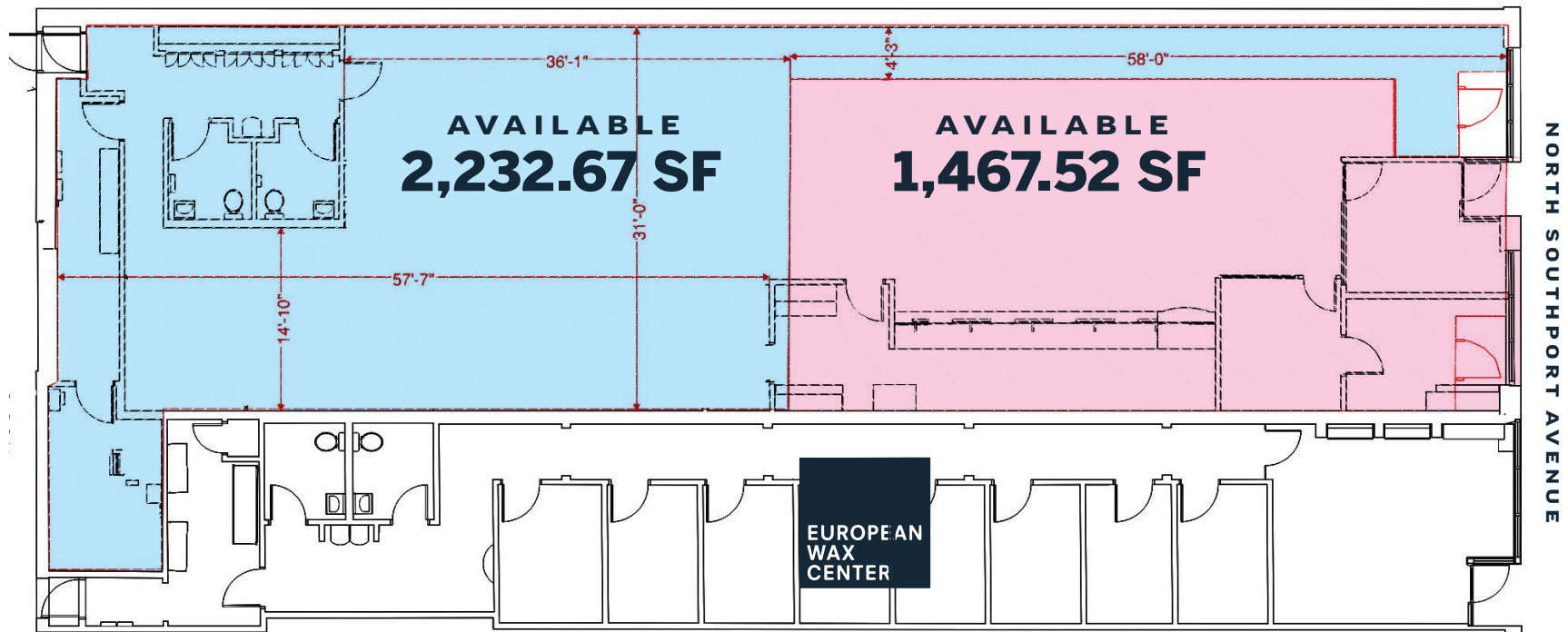

CANVAS





# STREET MAP

**3730 N. Southport Avenue**  
CHICAGO, ILLINOIS

**SPACE AVAILABLE**



**FOR MORE INFORMATION,  
PLEASE CONTACT**

**ANTHONY CAMPAGNI**  
ac@canvasrealestate.com  
847.651.8669

**ELAN RASANSKY**  
elan@canvasrealestate.com  
414.380.1555

**QUINN THOMAS**  
qthomas@canvasrealestate.com  
847.651.5589

**CANVAS**

