

UNDER NEW OWNERSHIP



3020 N. Ashland Avenue
CHICAGO, ILLINOIS

Former Restaurant Building Available for Lease
Southwest corner of Ashland and Nelson

FOR MORE INFORMATION,
PLEASE CONTACT

ANTHONY CAMPAGNI
ac@canvasrealestate.com
847.651.8669

ELAN RASANSKY
elan@canvasrealestate.com
414.380.1555

DEMOGRAPHICS



69.7k+

Total Population
1 Mile

81k+ 8.05k+
0.5 Miles 0.25 Miles



\$123k+

Average HH Income
1 Mile

\$109k+ \$83.4k+
0.5 Miles 0.25 Miles



60.3k+

Daytime Population
1 Mile

119k+ 21.7k+
0.5 Miles 0.25 Miles



LAKEVIEW

- Join the #1 Jewel in Chicago and over \$100 million in grocer sales within a 3-block radius.
- 2nd generation restaurant with existing drive-thru in the heart of Lakeview.
- Cross-parking available with neighboring shopping center.
- Located just south of Ashland, Lincoln, Belmont intersection with high traffic counts along Ashland (27,000 VPD).
- Building can be demised.

NEIGHBORING RETAILERS

Chipotle, Dunkin', Foss Swim School, F45, Jewel-Osco, Orange Theory Fitness, The Art of Pizza, Whole Foods, Xfinity

CANVAS

SITE PLAN

SPACE AVAILABLE

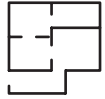

4,342 sqft

Total

PARKING



28

Parking Spaces +
Cross-Parking



CANVAS



STREET MAP

3020 N. Ashland Avenue
CHICAGO, ILLINOIS

SPACE AVAILABLE



FOR MORE INFORMATION,
PLEASE CONTACT

ANTHONY CAMPAGNI
ac@canvasrealestate.com
847.651.8669

ELAN RASANSKY
elan@canvasrealestate.com
414.380.1555

CANVAS

