



701 NMA is an exclusive opportunity to be a part of history
on one of the world's most celebrated thoroughfares
ANCHORED BY A BRAND NEW ROLEX FLAGSHIP

701 NORTH MICHIGAN AVENUE

CANVAS

NMA



**Occupy a trophy retail position at the base
of the landmarked Warwick Allerton Hotel
anchored by a brand new Rolex flagship
on Chicago's Magnificent Mile**

Over 12,000 square feet remains available and divisible
on two levels fronting North Michigan Avenue, one of the most
frequented destination retail shopping districts in the world

Approximately 6,000 square feet of basement and
sub-basement storage space also available

Well-positioned amongst prestigious global brands
including Neiman Marcus, Saks Fifth Avenue,
Ferragamo, Ermenegildo Zegna, Burberry, ALO Yoga,
Aritzia, Polo Ralph Lauren, and Tiffany & Co.

Built in 1924 and designated a Chicago Landmark in 1998

Flexible delivery and Multiple demising scenarios are available.



GROUND FLOOR

RETAIL SPACE #101 - 6,370 SF
RETAIL SPACE #102 - 2,735 SF

TOTAL COMBINED
GROUND FLOOR SPACE = 9,105 SF

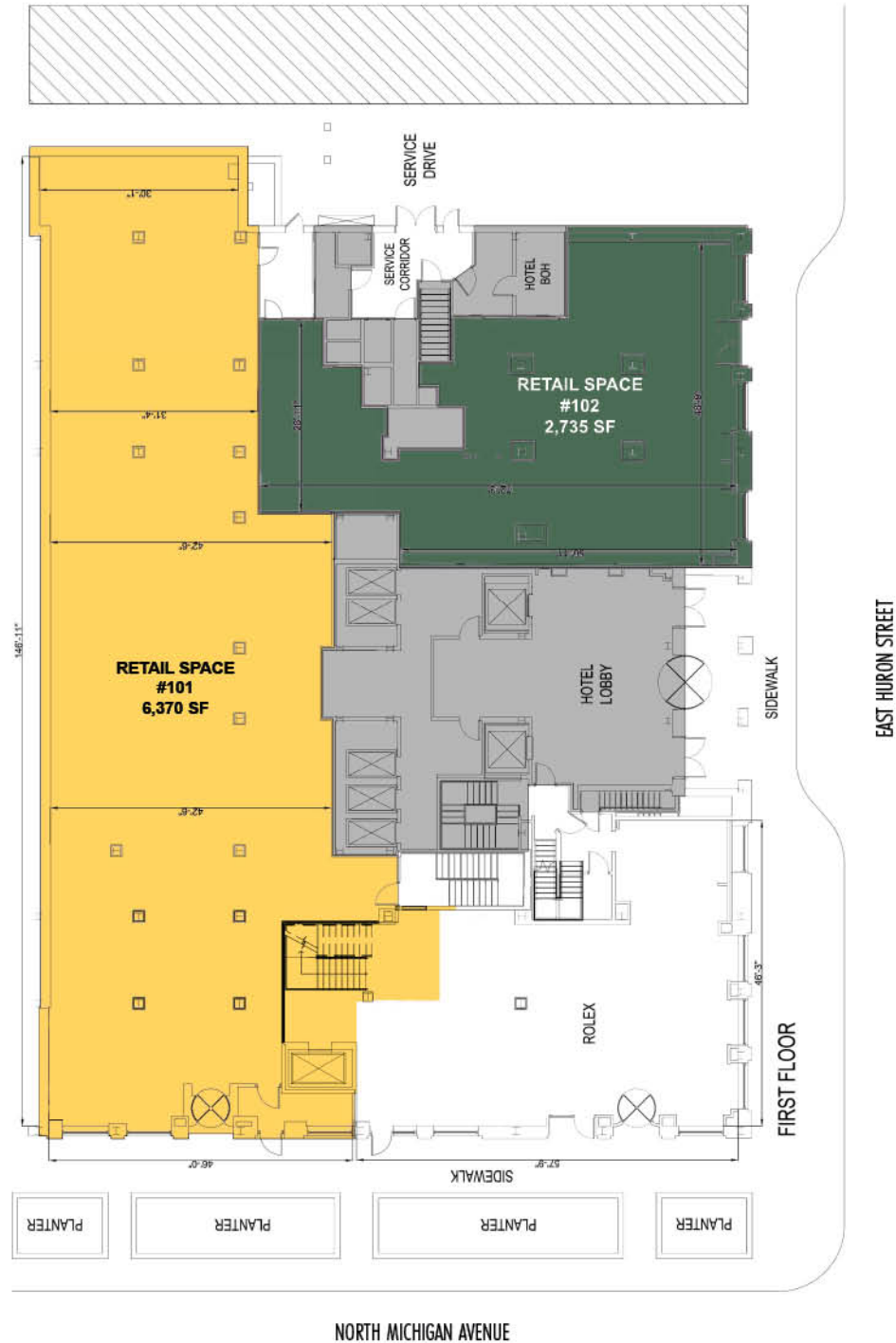

701
NMA



SECOND FLOOR
RETAIL SPACE #201 - 3,645 SF

701
NMA

THE MAGNIFICENT MILE SUB-MARKET



Home to more than 3.2 million square feet of retail space and more than 17.7 million square feet of office space



In excess of \$2.3B in annual retail and F&B sales



Over 40,000 pedestrians per day on weekdays and over 55,000 on weekends



Daytime population in excess of 302,819 within one mile



Over 49 million visitors annually to Chicago, with over 30 million annual visitors to the Magnificent Mile



Total of 64 hotels with 21,563 hotel rooms in the North Michigan Avenue district, accounting for 75% of all downtown hotel rooms

701
W 14th



CANVAS

ANTHONY CAMPAGNI
ac@canvasrealestate.com
847.651.8669

ELAN RASANSKY
elan@canvasrealestate.com
414.380.1555