

1241 N. Milwaukee Avenue

CHICAGO, ILLINOIS

Retail Space for Lease

NWC of Milwaukee Avenue & Ashland Avenue

FOR MORE INFORMATION, PLEASE CONTACT

ANDREW BECKER • 312.231.2600
abecker@canvasrealestate.com

MICHAEL WEXLER • 773.426.1759
mwexler@canvasrealestate.com

JOHN BASSI • 708.822.4583
jbassi@canvasrealestate.com

DEMOGRAPHICS



55.2k+

Total Population
1 Mile

19.2k+
0.5 Miles



\$198k+

Average HH Income
1 Mile

\$206k+
0.5 Miles



58.6k+

Daytime Population
1 Mile

14.4k+
0.5 Miles



PREMISES

- Small Shop Space Available in Wicker Park
- ± 2,333 of versatile ground-floor retail space available at the base of an 60-unit residential development (98.3%occupied)
- Strong national and daily needs co-tenancy include: Jewel, Lowes, Ulta, Pet Supplies Plus, and more

HIGHLIGHTS

- Highly visible, off-corner position alongside high-traffic intersection of Ashland, Milwaukee, and Division St (26,800 vpd)
- Adjacent Blue Line CTA Division (1,929,330 annual ridership) station drives high morning/evening commuter traffic to site

NEIGHBORING RETAILERS

Advocate Medical Group, City Sports, Dunkin', Extra Space Storage, Fifth Third Bank, H&R Block, Popeyes, Potbelly, The Cauldron, Ulta and many more.

CANVAS

SITE PLAN

SPACE AVAILABLE



2,333^{sf}

Total

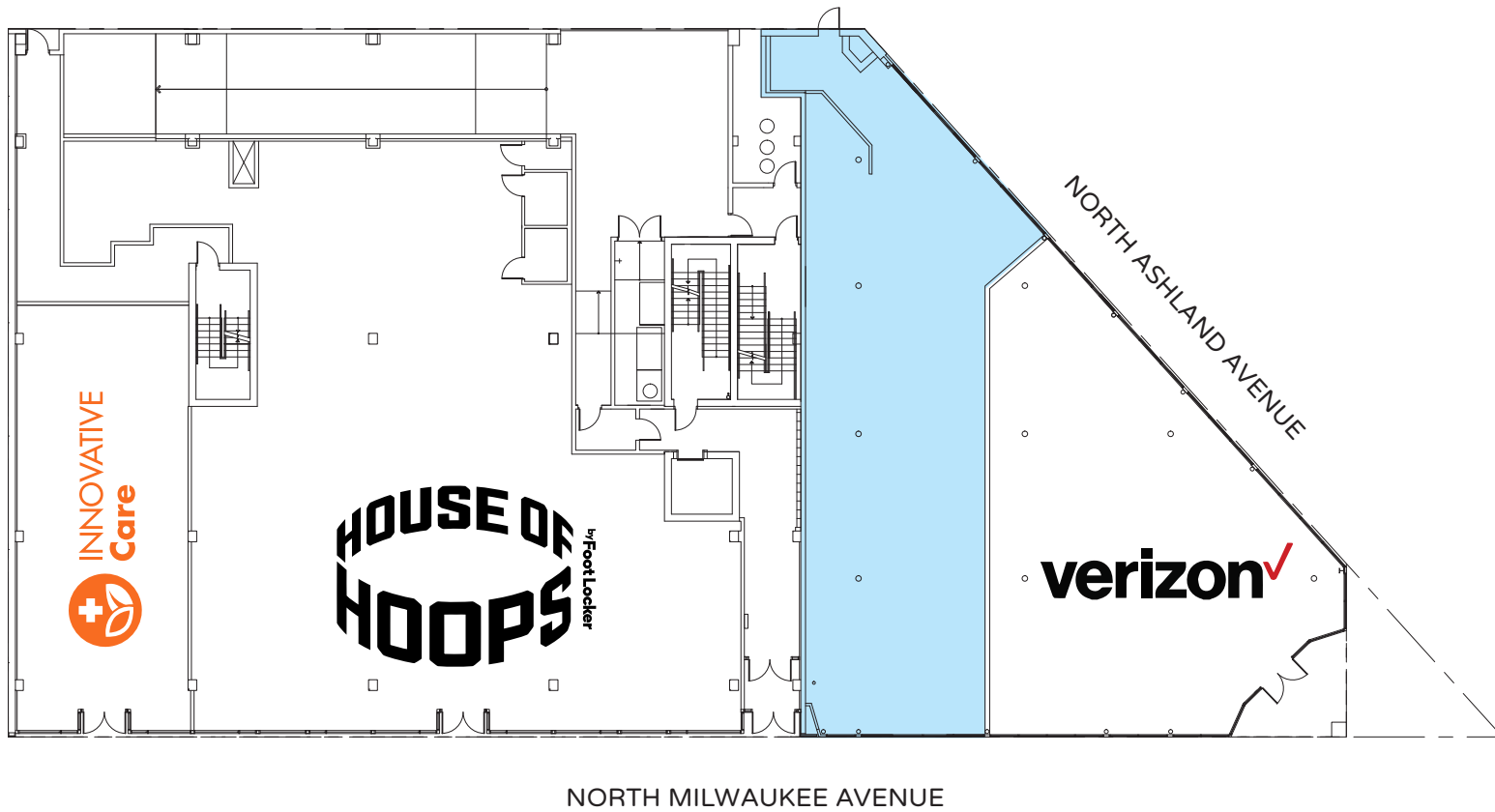

CANVAS



STREET MAP

1241 N. Milwaukee Avenue
CHICAGO, ILLINOIS

SPACE FOR LEASE



**FOR MORE INFORMATION,
PLEASE CONTACT**

ANDREW BECKER

abecker@canvasrealestate.com
312.231.2600

MICHAEL WEXLER

mwexler@canvasrealestate.com
773.426.1759

JOHN BASSI

jbassi@canvasrealestate.com
708.822.4583

CANVAS · CIM

