

# 1353 W FULTON ST

Chicago's Next Great Fulton Market Corner

Adjacent to Small Cheval and Chef Curtis Duffy's EVER / AFTER



13,217 RSF Available

AT THE BASE OF

STEAD 220

CANVAS

Shapack

# 1353 W FULTON ST

## Fulton Market District Retail

13,217 RSF of newly delivered retail at one of Fulton Market District's most prominent western intersections.

Positioned on the hard corner of Fulton and Ada, the space benefits from exceptional Fulton Street frontage, wide sidewalks, covered outdoor space, and direct adjacency to one of Chicago's fastest-growing residential and office districts.

As Fulton Market continues its expansion west and the future 1901 Project beginning construction, 1353 W Fulton sits at the center of the neighborhood's next chapter.

### HIGHLIGHTS

- Newly delivered retail in a supply-constrained district
- Approximately 200 feet of Ada Street frontage and 100 feet of Fulton Street frontage
- Located below 308 new residences at Stead 220
- Flexible demising configurations available
- Strong pedestrian visibility and corner presence
- Covered outdoor space integrated into the retail experience
- Ideal for restaurant, wellness, retail, fitness, and experiential concepts

1353 W Fulton St



CANVAS + Shapack Partners

# RETAIL PLAN

13,217 RSF Total

The ground floor retail opportunity consists of 12,324 RSF of interior space with an additional 893 RSF of covered outdoor space positioned at the project's hard corner.

The space can be demised into multiple configurations, offering flexibility for restaurant, retail, wellness, fitness, and experiential concepts.

Expansive sidewalks along both Fulton and Ada create the opportunity for outdoor seating, retail display, and activation as a seamless extension of the tenant experience.

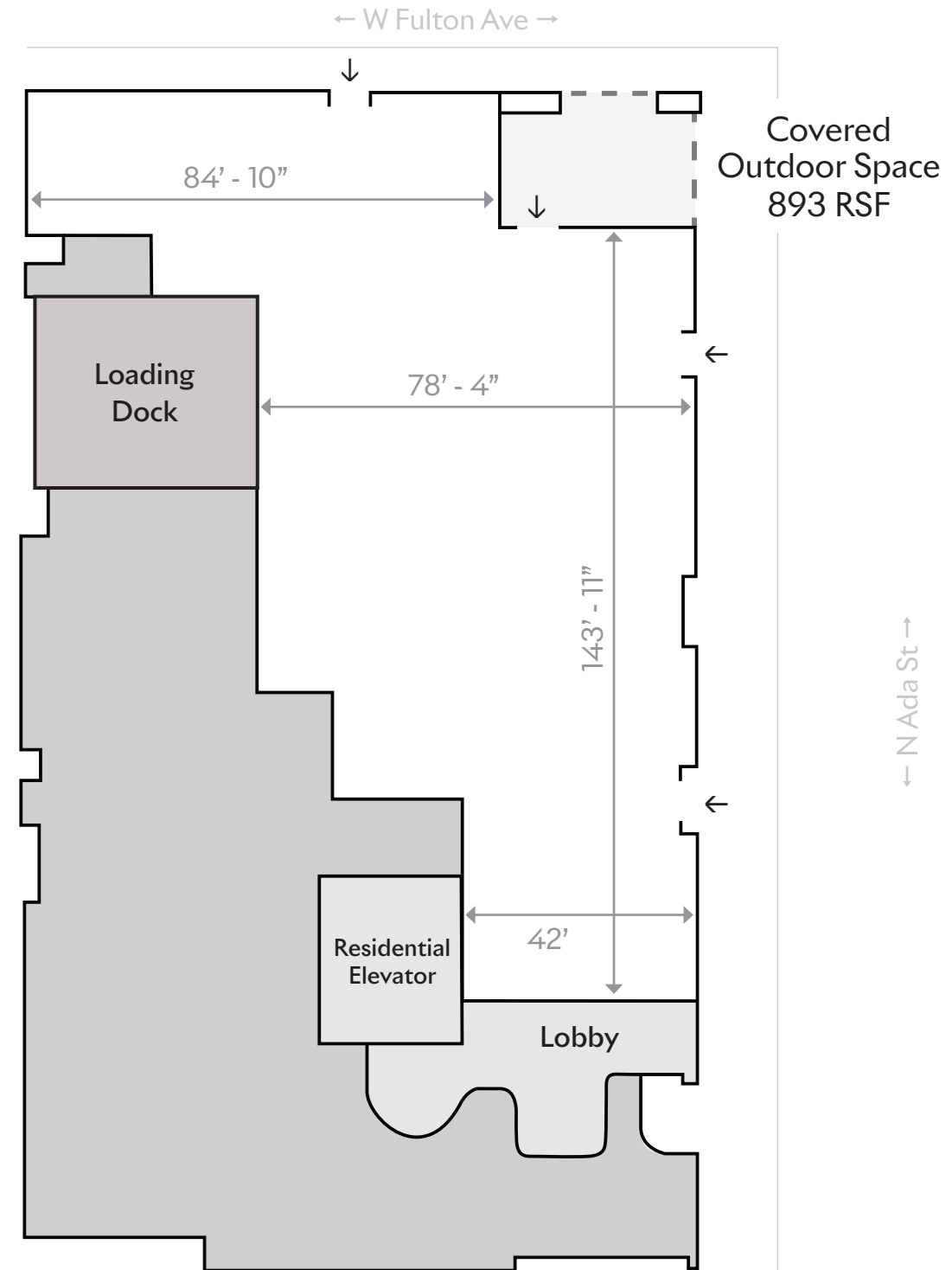

Ceiling Clear Heights 14'4" - 16'

# OPTIONAL DEMISING PLAN

13,217 RSF Total

## RETAIL A

2,350 RSF

## RETAIL B







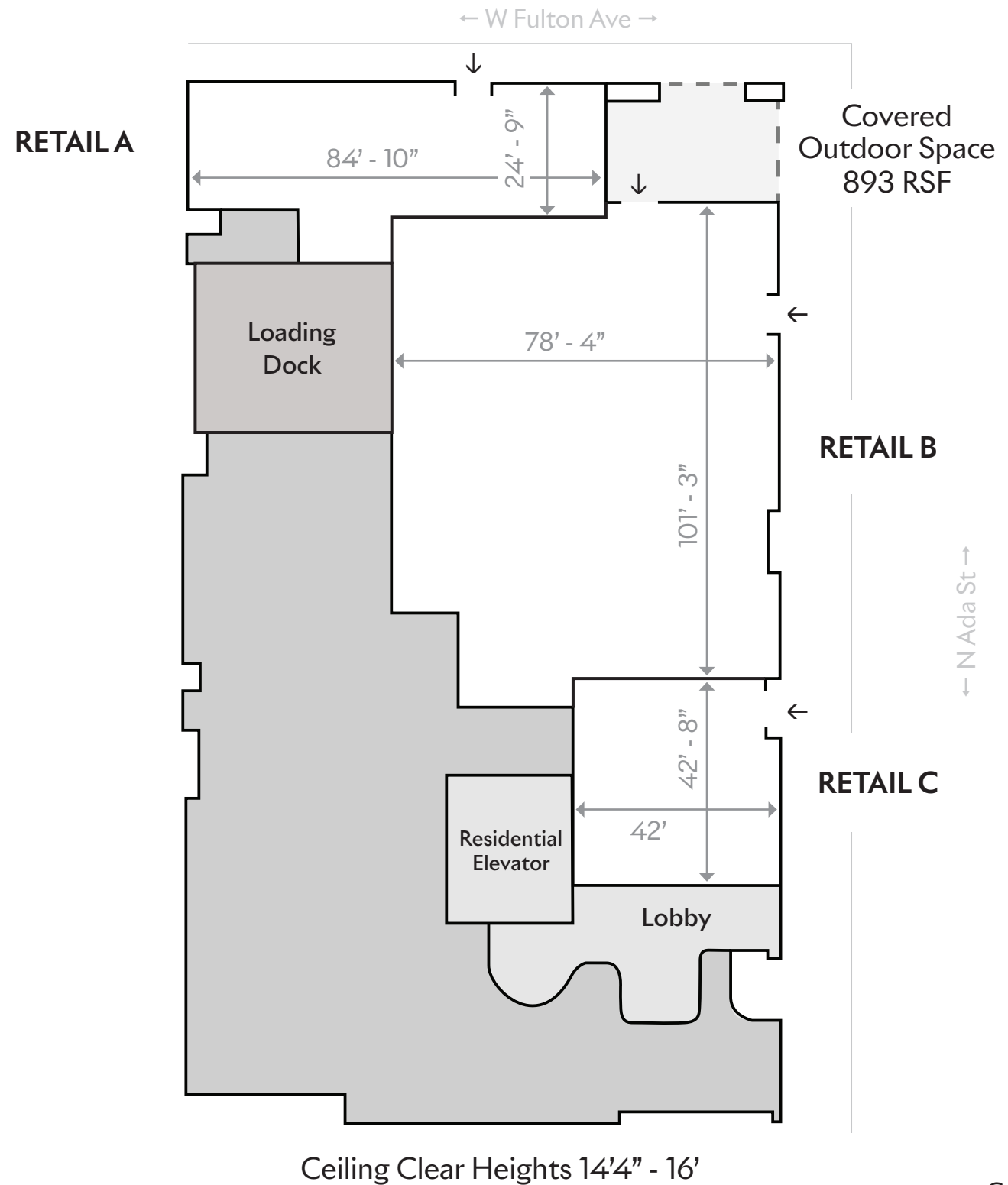



7,450 RSF

## RETAIL C

1,750 RSF

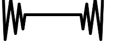

# FULTON MARKET CO-TENANCY BY CATEGORY

RESTAURANTS		RETAIL		WELLNESS
<p><i>Au Cheval</i></p> <p>MOMOTARO</p> <p>GIRL &amp; THE GOAT</p>  <p>MONTEVERDE®</p> <p><i>rose mary</i></p> <p>thePUBLICAN</p> <p><b>GIBSONS</b> BAR • STEAKHOUSE</p> <p><b>BAR TUTTO</b></p> <p>SHAKE  SHACK®</p>	<p><b>bisous</b></p> <p> Mendocino Farms</p> <p>sushi<b>DOKKU</b></p> <p>εστιατόριο <b>LÝRA</b></p> <p><b>aba</b></p> <p> SWIFT &amp; SONS STEAKHOUSE</p> <p>La <b>COLOMBE</b> TORREFACTION</p> <p>swæetgreen®</p>	<p>lululemon  athletica</p> <p>BILLY REID</p> <p>WARBY PARKER</p> <p>BEYOND YOGA</p> <p><b>Reformation</b></p> <p><i>Madewell</i></p> <p><b>patagonia</b>®</p> <p>MEJURI</p>	<p> <b>FJÄLL RÄVEN</b></p> <p> BREITLING 1884</p> <p><b>Ω OMEGA</b></p> <p><b>H HUBLOT</b></p> <p> <i>H. Moser &amp; Cie.</i> VERY RARE</p> <p><i>bl</i></p>	<p>EQUINOX®</p> <p><b>[solidcore]</b></p> <p><b>STUDIO ///</b></p> <p> BODYBAR PILATES</p> <p> <b>STUDIO LAGREE</b></p> <p> PAGE ONE PILATES</p>

# FULTON MARKET RETAIL MAP



As Fulton Market continues its expansion west, 1353 W Fulton sits at one of the neighborhood's most important emerging intersections.



CANVAS

**ANDREW BECKER**

312.231.2600

[abecker@canvasrealestate.com](mailto:abecker@canvasrealestate.com)

**MICHAEL WEXLER**

773.426.1759

[mwexler@canvasrealestate.com](mailto:mwexler@canvasrealestate.com)

**JOHN BASSI**

708.822.4583

[jbassi@canvasrealestate.com](mailto:jbassi@canvasrealestate.com)

SHAPACK PARTNERS

**PAIGE O'NEIL**

708.704.7833

[poneil@shapack.com](mailto:poneil@shapack.com)

CANVAS

Shapack